



- LEGEND**
- Site Boundary
 - Existing 200mm uPVC Water Supply Pipe
 - Proposed PE 100 SDR 17 Water Supply Pipe
 - Proposed PE 150 SDR 17 Water Supply Pipe
 - Proposed Water Meter
 - Proposed Sluice Valve
 - Proposed Fire Hydrant
 - Proposed Bulk Meter
 - Proposed Air Valve
 - Proposed Scour Valve
 - Proposed Level
 - Proposed 25mm House Connections

NOTES:

- IN-COS-50/2/03: CONNECTIONS TO ENCUMBER A MINIMUM OF FOUR HOUSE CONNECTIONS OR TWO HOUSE CONNECTIONS AND A FIRE HYDRANT
- WATERMANS TO BE A MINIMUM 1.5m FROM THE KERB AND 300mm FROM ANY OTHER SERVICE, TYPICAL SERVICE LAYOUT DISTANCES HORIZONTALLY AND VERTICALLY AS PER SERVICE (STD-W-11)
- DECIDUOUS TREES (STD-W-12)
- WATERMANS TO BE KEPT 1.5m TO 2.0m FROM TREES WITH ROOT PROTECTION. TREES TO BE NO GREATER THAN MEDIUM SIZE, AS PER IN-COS-50/2/03 E.G. NSI, WHITEBARK OR SIMILAR. REDWOOD 7500 OR SIMILAR
- WATERMANS TO BE KEPT 1.5m TO 2.0m FROM TREES WITH ROOT PROTECTION. TREES TO BE NO GREATER THAN MEDIUM SIZE, AS PER IN-COS-50/2/03 E.G. NSI, WHITEBARK OR SIMILAR. REDWOOD 7500 OR SIMILAR
- LOCATION OF VALVES, MANHOLES, HYDRANTS ARE SHOWN INDIICATIVE ONLY ON THIS DRAWING. IT IS THE CONTRACTORS RESPONSIBILITY TO ENSURE THAT THE POSITIONS ON THE GROUND ARE IN ACCORDANCE WITH IN-COS-50/2/03

NOTES:

Water main house connections to comply with Refer to STD-W-12A, STD-W-12B, STD-W-12C, STD-W-12D, STD-W-12E, STD-W-12F, STD-W-12G, STD-W-12H, STD-W-12I, STD-W-12J, STD-W-12K, STD-W-12L, STD-W-12M, STD-W-12N, STD-W-12O, STD-W-12P, STD-W-12Q, STD-W-12R, STD-W-12S, STD-W-12T, STD-W-12U, STD-W-12V, STD-W-12W, STD-W-12X, STD-W-12Y, STD-W-12Z, STD-W-12AA, STD-W-12AB, STD-W-12AC, STD-W-12AD, STD-W-12AE, STD-W-12AF, STD-W-12AG, STD-W-12AH, STD-W-12AI, STD-W-12AJ, STD-W-12AK, STD-W-12AL, STD-W-12AM, STD-W-12AN, STD-W-12AO, STD-W-12AP, STD-W-12AQ, STD-W-12AR, STD-W-12AS, STD-W-12AT, STD-W-12AU, STD-W-12AV, STD-W-12AW, STD-W-12AX, STD-W-12AY, STD-W-12AZ, STD-W-12BA, STD-W-12BB, STD-W-12BC, STD-W-12BD, STD-W-12BE, STD-W-12BF, STD-W-12BG, STD-W-12BH, STD-W-12BI, STD-W-12BJ, STD-W-12BK, STD-W-12BL, STD-W-12BM, STD-W-12BN, STD-W-12BO, STD-W-12BP, STD-W-12BQ, STD-W-12BR, STD-W-12BS, STD-W-12BT, STD-W-12BU, STD-W-12BV, STD-W-12BW, STD-W-12BX, STD-W-12BY, STD-W-12BZ, STD-W-12CA, STD-W-12CB, STD-W-12CC, STD-W-12CD, STD-W-12CE, STD-W-12CF, STD-W-12CG, STD-W-12CH, STD-W-12CI, STD-W-12CJ, STD-W-12CK, STD-W-12CL, STD-W-12CM, STD-W-12CN, STD-W-12CO, STD-W-12CP, STD-W-12CQ, STD-W-12CR, STD-W-12CS, STD-W-12CT, STD-W-12CU, STD-W-12CV, STD-W-12CW, STD-W-12CX, STD-W-12CY, STD-W-12CZ, STD-W-12DA, STD-W-12DB, STD-W-12DC, STD-W-12DD, STD-W-12DE, STD-W-12DF, STD-W-12DG, STD-W-12DH, STD-W-12DI, STD-W-12DJ, STD-W-12DK, STD-W-12DL, STD-W-12DM, STD-W-12DN, STD-W-12DO, STD-W-12DP, STD-W-12DQ, STD-W-12DR, STD-W-12DS, STD-W-12DT, STD-W-12DU, STD-W-12DV, STD-W-12DW, STD-W-12DX, STD-W-12DY, STD-W-12DZ, STD-W-12EA, STD-W-12EB, STD-W-12EC, STD-W-12ED, STD-W-12EE, STD-W-12EF, STD-W-12EG, STD-W-12EH, STD-W-12EI, STD-W-12EJ, STD-W-12EK, STD-W-12EL, STD-W-12EM, STD-W-12EN, STD-W-12EO, STD-W-12EP, STD-W-12EQ, STD-W-12ER, STD-W-12ES, STD-W-12ET, STD-W-12EU, STD-W-12EV, STD-W-12EW, STD-W-12EX, STD-W-12EY, STD-W-12EZ, STD-W-12FA, STD-W-12FB, STD-W-12FC, STD-W-12FD, STD-W-12FE, STD-W-12FF, STD-W-12FG, STD-W-12FH, STD-W-12FI, STD-W-12FJ, STD-W-12FK, STD-W-12FL, STD-W-12FM, STD-W-12FN, STD-W-12FO, STD-W-12FP, STD-W-12FQ, STD-W-12FR, STD-W-12FS, STD-W-12FT, STD-W-12FU, STD-W-12FV, STD-W-12FW, STD-W-12FX, STD-W-12FY, STD-W-12FZ, STD-W-12GA, STD-W-12GB, STD-W-12GC, STD-W-12GD, STD-W-12GE, STD-W-12GF, STD-W-12GG, STD-W-12GH, STD-W-12GI, STD-W-12GJ, STD-W-12GK, STD-W-12GL, STD-W-12GM, STD-W-12GN, STD-W-12GO, STD-W-12GP, STD-W-12GQ, STD-W-12GR, STD-W-12GS, STD-W-12GT, STD-W-12GU, STD-W-12GV, STD-W-12GW, STD-W-12GX, STD-W-12GY, STD-W-12GZ, STD-W-12HA, STD-W-12HB, STD-W-12HC, STD-W-12HD, STD-W-12HE, STD-W-12HF, STD-W-12HG, STD-W-12HH, STD-W-12HI, STD-W-12HJ, STD-W-12HK, STD-W-12HL, STD-W-12HM, STD-W-12HN, STD-W-12HO, STD-W-12HP, STD-W-12HQ, STD-W-12HR, STD-W-12HS, STD-W-12HT, STD-W-12HU, STD-W-12HV, STD-W-12HW, STD-W-12HX, STD-W-12HY, STD-W-12HZ, STD-W-12IA, STD-W-12IB, STD-W-12IC, STD-W-12ID, STD-W-12IE, STD-W-12IF, STD-W-12IG, STD-W-12IH, STD-W-12II, STD-W-12IJ, STD-W-12IK, STD-W-12IL, STD-W-12IM, STD-W-12IN, STD-W-12IO, STD-W-12IP, STD-W-12IQ, STD-W-12IR, STD-W-12IS, STD-W-12IT, STD-W-12IU, STD-W-12IV, STD-W-12IW, STD-W-12IX, STD-W-12IY, STD-W-12IZ, STD-W-12JA, STD-W-12JB, STD-W-12JC, STD-W-12JD, STD-W-12JE, STD-W-12JF, STD-W-12JG, STD-W-12JH, STD-W-12JI, STD-W-12JJ, STD-W-12JK, STD-W-12JL, STD-W-12JM, STD-W-12JN, STD-W-12JO, STD-W-12JP, STD-W-12JQ, STD-W-12JR, STD-W-12JS, STD-W-12JT, STD-W-12JU, STD-W-12JV, STD-W-12JW, STD-W-12JX, STD-W-12JY, STD-W-12JZ, STD-W-12KA, STD-W-12KB, STD-W-12KC, STD-W-12KD, STD-W-12KE, STD-W-12KF, STD-W-12KG, STD-W-12KH, STD-W-12KI, STD-W-12KJ, STD-W-12KL, STD-W-12KM, STD-W-12KN, STD-W-12KO, STD-W-12KP, STD-W-12KQ, STD-W-12KR, STD-W-12KS, STD-W-12KT, STD-W-12KU, STD-W-12KV, STD-W-12KW, STD-W-12KX, STD-W-12KY, STD-W-12KZ, STD-W-12LA, STD-W-12LB, STD-W-12LC, STD-W-12LD, STD-W-12LE, STD-W-12LF, STD-W-12LG, STD-W-12LH, STD-W-12LI, STD-W-12LJ, STD-W-12LK, STD-W-12LL, STD-W-12LM, STD-W-12LN, STD-W-12LO, STD-W-12LP, STD-W-12LQ, STD-W-12LR, STD-W-12LS, STD-W-12LT, STD-W-12LU, STD-W-12LV, STD-W-12LW, STD-W-12LX, STD-W-12LY, STD-W-12LZ, STD-W-12MA, STD-W-12MB, STD-W-12MC, STD-W-12MD, STD-W-12ME, STD-W-12MF, STD-W-12MG, STD-W-12MH, STD-W-12MI, STD-W-12MJ, STD-W-12MK, STD-W-12ML, STD-W-12MN, STD-W-12MO, STD-W-12MP, STD-W-12MQ, STD-W-12MR, STD-W-12MS, STD-W-12MT, STD-W-12MU, STD-W-12MV, STD-W-12MW, STD-W-12MX, STD-W-12MY, STD-W-12MZ, STD-W-12NA, STD-W-12NB, STD-W-12NC, STD-W-12ND, STD-W-12NE, STD-W-12NF, STD-W-12NG, STD-W-12NH, STD-W-12NI, STD-W-12NJ, STD-W-12NK, STD-W-12NL, STD-W-12NM, STD-W-12NO, STD-W-12NP, STD-W-12NQ, STD-W-12NR, STD-W-12NS, STD-W-12NT, STD-W-12NU, STD-W-12NV, STD-W-12NW, STD-W-12NX, STD-W-12NY, STD-W-12NZ, STD-W-12OA, STD-W-12OB, STD-W-12OC, STD-W-12OD, STD-W-12OE, STD-W-12OF, STD-W-12OG, STD-W-12OH, STD-W-12OI, STD-W-12OJ, STD-W-12OK, STD-W-12OL, STD-W-12OM, STD-W-12ON, STD-W-12OO, STD-W-12OP, STD-W-12OQ, STD-W-12OR, STD-W-12OS, STD-W-12OT, STD-W-12OU, STD-W-12OV, STD-W-12OW, STD-W-12OX, STD-W-12OY, STD-W-12OZ, STD-W-12PA, STD-W-12PB, STD-W-12PC, STD-W-12PD, STD-W-12PE, STD-W-12PF, STD-W-12PG, STD-W-12PH, STD-W-12PI, STD-W-12PJ, STD-W-12PK, STD-W-12PL, STD-W-12PM, STD-W-12PN, STD-W-12PO, STD-W-12PP, STD-W-12PQ, STD-W-12PR, STD-W-12PS, STD-W-12PT, STD-W-12PU, STD-W-12PV, STD-W-12PW, STD-W-12PX, STD-W-12PY, STD-W-12PZ, STD-W-12QA, STD-W-12QB, STD-W-12QC, STD-W-12QD, STD-W-12QE, STD-W-12QF, STD-W-12QG, STD-W-12QH, STD-W-12QI, STD-W-12QJ, STD-W-12QK, STD-W-12QL, STD-W-12QM, STD-W-12QN, STD-W-12QO, STD-W-12QP, STD-W-12QQ, STD-W-12QR, STD-W-12QS, STD-W-12QT, STD-W-12QU, STD-W-12QV, STD-W-12QW, STD-W-12QX, STD-W-12QY, STD-W-12QZ, STD-W-12RA, STD-W-12RB, STD-W-12RC, STD-W-12RD, STD-W-12RE, STD-W-12RF, STD-W-12RG, STD-W-12RH, STD-W-12RI, STD-W-12RJ, STD-W-12RK, STD-W-12RL, STD-W-12RM, STD-W-12RN, STD-W-12RO, STD-W-12RP, STD-W-12RQ, STD-W-12RR, STD-W-12RS, STD-W-12RT, STD-W-12RU, STD-W-12RV, STD-W-12RW, STD-W-12RX, STD-W-12RY, STD-W-12RZ, STD-W-12SA, STD-W-12SB, STD-W-12SC, STD-W-12SD, STD-W-12SE, STD-W-12SF, STD-W-12SG, STD-W-12SH, STD-W-12SI, STD-W-12SJ, STD-W-12SK, STD-W-12SL, STD-W-12SM, STD-W-12SN, STD-W-12SO, STD-W-12SP, STD-W-12SQ, STD-W-12SR, STD-W-12SS, STD-W-12ST, STD-W-12SU, STD-W-12SV, STD-W-12SW, STD-W-12SX, STD-W-12SY, STD-W-12SZ, STD-W-12TA, STD-W-12TB, STD-W-12TC, STD-W-12TD, STD-W-12TE, STD-W-12TF, STD-W-12TG, STD-W-12TH, STD-W-12TI, STD-W-12TJ, STD-W-12TK, STD-W-12TL, STD-W-12TM, STD-W-12TN, STD-W-12TO, STD-W-12TP, STD-W-12TQ, STD-W-12TR, STD-W-12TS, STD-W-12TT, STD-W-12TU, STD-W-12TV, STD-W-12TW, STD-W-12TX, STD-W-12TY, STD-W-12TZ, STD-W-12UA, STD-W-12UB, STD-W-12UC, STD-W-12UD, STD-W-12UE, STD-W-12UF, STD-W-12UG, STD-W-12UH, STD-W-12UI, STD-W-12UJ, STD-W-12UK, STD-W-12UL, STD-W-12UM, STD-W-12UN, STD-W-12UO, STD-W-12UP, STD-W-12UQ, STD-W-12UR, STD-W-12US, STD-W-12UT, STD-W-12UU, STD-W-12UV, STD-W-12UW, STD-W-12UX, STD-W-12UY, STD-W-12UZ, STD-W-12VA, STD-W-12VB, STD-W-12VC, STD-W-12VD, STD-W-12VE, STD-W-12VF, STD-W-12VG, STD-W-12VH, STD-W-12VI, STD-W-12VJ, STD-W-12VK, STD-W-12VL, STD-W-12VM, STD-W-12VN, STD-W-12VO, STD-W-12VP, STD-W-12VQ, STD-W-12VR, STD-W-12VS, STD-W-12VT, STD-W-12VU, STD-W-12VV, STD-W-12VW, STD-W-12VX, STD-W-12VY, STD-W-12VZ, STD-W-12WA, STD-W-12WB, STD-W-12WC, STD-W-12WD, STD-W-12WE, STD-W-12WF, STD-W-12WG, STD-W-12WH, STD-W-12WI, STD-W-12WJ, STD-W-12WK, STD-W-12WL, STD-W-12WM, STD-W-12WN, STD-W-12WO, STD-W-12WP, STD-W-12WQ, STD-W-12WR, STD-W-12WS, STD-W-12WT, STD-W-12WU, STD-W-12WV, STD-W-12WW, STD-W-12WX, STD-W-12WY, STD-W-12WZ, STD-W-12XA, STD-W-12XB, STD-W-12XC, STD-W-12XD, STD-W-12XE, STD-W-12XF, STD-W-12XG, STD-W-12XH, STD-W-12XI, STD-W-12XJ, STD-W-12XK, STD-W-12XL, STD-W-12XM, STD-W-12XN, STD-W-12XO, STD-W-12XP, STD-W-12XQ, STD-W-12XR, STD-W-12XS, STD-W-12XT, STD-W-12XU, STD-W-12XV, STD-W-12XW, STD-W-12XX, STD-W-12XY, STD-W-12XZ, STD-W-12YA, STD-W-12YB, STD-W-12YC, STD-W-12YD, STD-W-12YE, STD-W-12YF, STD-W-12YG, STD-W-12YH, STD-W-12YI, STD-W-12YJ, STD-W-12YK, STD-W-12YL, STD-W-12YM, STD-W-12YN, STD-W-12YO, STD-W-12YP, STD-W-12YQ, STD-W-12YR, STD-W-12YS, STD-W-12YT, STD-W-12YU, STD-W-12YV, STD-W-12YW, STD-W-12YX, STD-W-12YY, STD-W-12YZ, STD-W-12ZA, STD-W-12ZB, STD-W-12ZC, STD-W-12ZD, STD-W-12ZE, STD-W-12ZF, STD-W-12ZG, STD-W-12ZH, STD-W-12ZI, STD-W-12ZJ, STD-W-12ZK, STD-W-12ZL, STD-W-12ZM, STD-W-12ZN, STD-W-12ZO, STD-W-12ZP, STD-W-12ZQ, STD-W-12ZR, STD-W-12ZS, STD-W-12ZT, STD-W-12ZU, STD-W-12ZV, STD-W-12ZW, STD-W-12ZX, STD-W-12ZY, STD-W-12ZZ

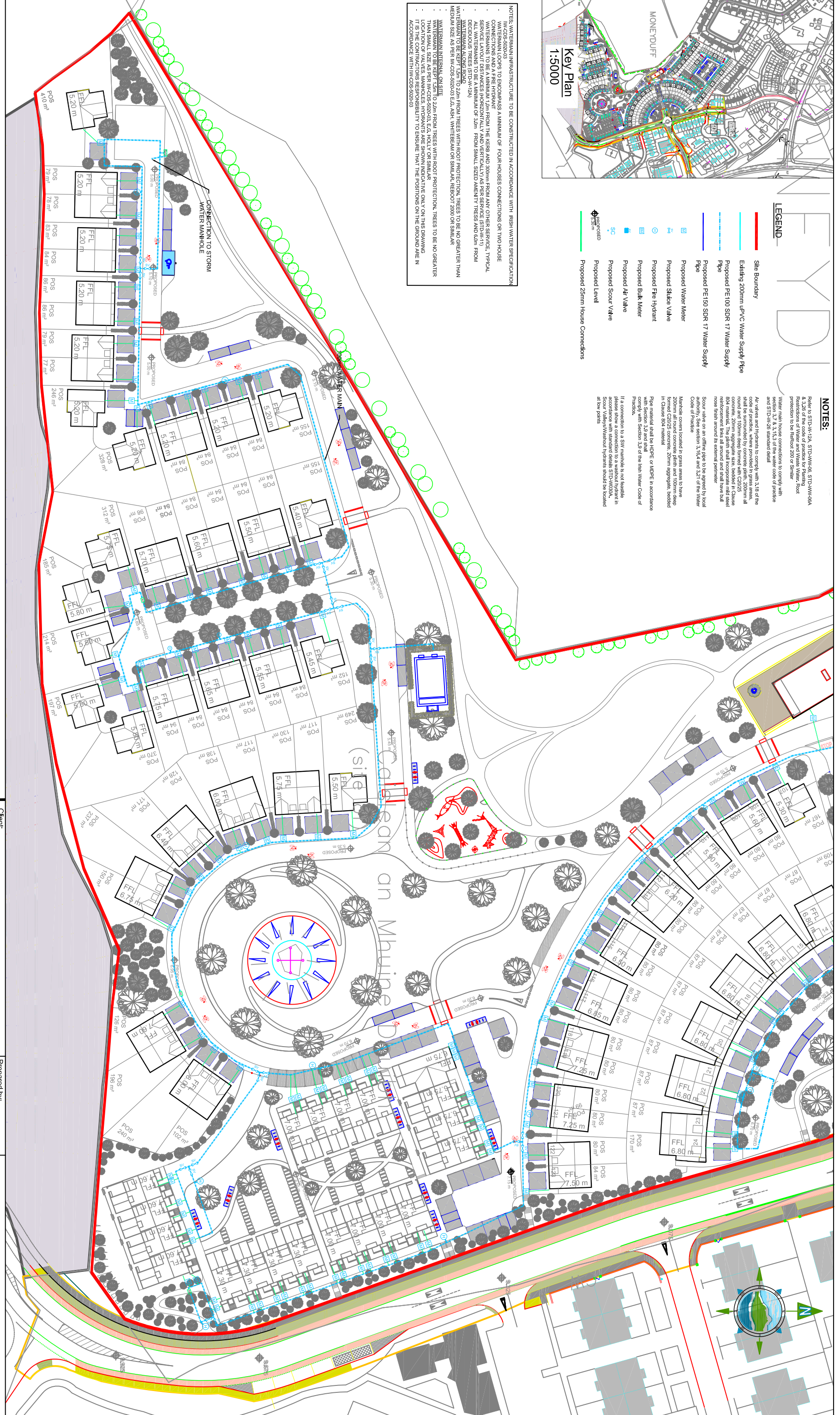

- NOTES:**
1. FIGURED DIMENSIONS ONLY, TO BE TAKEN FROM THIS DRAWING.
 2. DRAWINGS TO BE CHECKED BY THE CONTRACTOR APPROPRIATE. TO BE INFORMED BY THE CONTRACTOR OF ANY DISCREPANCIES BEFORE ANY WORK COMMENCES.
 3. ENGINEER/EMPLOYERS REPRESENTATIVE, AS APPROPRIATE, TO BE INFORMED BY THE CONTRACTOR BEFORE ANY WORK COMMENCES.
 4. THE CONTRACTOR SHALL UNDERTAKE A THOROUGH CHECK FOR THE ACTUAL LOCATION OF ALL SERVICES/UTILITIES, ABOVE AND BELOW GROUND, BEFORE ANY WORK COMMENCES.
 5. ALL LEVELS SHOWN RELATE TO ORDNANCE SURVEY DATUM AT MALIN HEAD.



Rev	Date	Description	By	Chkd.
A	20.06.2018	Issue for Planning	JK	BR
B	21.02.19	Final Water Revisions	FG	BR
C	07.03.19	Final Architect Layout (Minor Revisions)	FG	BR

Client: ARLUM LTD.
Project: Residential Development Moneyduff, Orammore Co. Galway
Title: Proposed Watermain Layout Part 1

Prepared by: JK
Checked: BR
Date: January 2018
Project Director: Michael McDonnell
Drawing Status: Planning
Scale @ A1: 1:500

TOBIN Consulting Engineers,
 Fairgreen House, Fairgreen Road,
 Galway, Ireland.
 telf: +353-(0)91-565211
 fax: +353-091-565298
 e-mail: galway@tobin.ie
 www.tobin.ie

Revision: **C**